

## Low form hexagon nuts

Steel / Stainless Steel, with a fine thread

### SPECIFICATION

#### Version in Steel

- Tensile strength class **04**
- blackened **BT**
- zinc plated, blue passivated **ZB**

#### Version in Stainless Steel

- Tensile strength class **035**
- AISI 304 (A2) **NI**
- AISI 316 (A4) **A4**

### INFORMATION

Low form hexagon nuts with a fine thread ISO 8675 are used in bolted connections, e.g. as lock nuts to lock components and prevent accidental loosening, turning or shifting. In addition, the nuts are also used together with indexing plungers, cam action indexing plungers, guide bushings or joint heads.

The flat design makes the hexagon nuts ideal for shorter threads. When mounting indexing plungers, they reduce the adjustment range only slightly, which may be of significance especially when using two lock nuts.

### ON REQUEST

- other threads

### TECHNICAL INFORMATION

- Stainless Steel characteristics (see page A26)

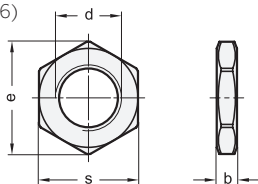

Examples of application

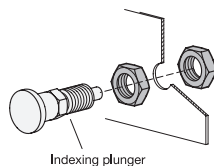
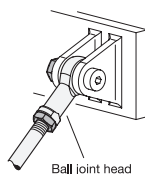
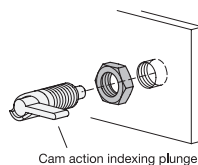

#### ISO 8675-BT

Description	d	b	e	s	⚖️
ISO 8675-M8x1-04-BT	M 8 x 1	4	14.4	13	3
ISO 8675-M10x1-04-BT	M 10 x 1	5	17.8	16	5
ISO 8675-M12x1,5-04-BT	M 12 x 1.5	6	20.1	18	8
ISO 8675-M16x1,5-04-BT	M 16 x 1.5	8	26.8	24	17
ISO 8675-M20x1,5-04-BT	M 20 x 1.5	10	33	30	31
ISO 8675-M24x2-04-BT	M 24 x 2	12	39.6	36	35

#### ISO 8675-ZB

Description	d	b	e	s	⚖️
ISO 8675-M8x1-04-ZB	M 8 x 1	4	14.4	13	3
ISO 8675-M10x1-04-ZB	M 10 x 1	5	17.8	16	5
ISO 8675-M12x1,5-04-ZB	M 12 x 1.5	6	20.1	18	9
ISO 8675-M16x1,5-04-ZB	M 16 x 1.5	8	26.8	24	18
ISO 8675-M20x1,5-04-ZB	M 20 x 1.5	10	33	30	32
ISO 8675-M24x2-04-ZB	M 24 x 2	12	39.6	36	35

#### ISO 8675-A4

STAINLESS STEEL

Description	d	b	e	s	⚖️
ISO 8675-M8x1-035-A4	M 8 x 1	4	14.4	13	3
ISO 8675-M10x1-035-A4	M 10 x 1	5	17.8	16	5
ISO 8675-M12x1,5-035-A4	M 12 x 1.5	6	20.1	18	8
ISO 8675-M16x1,5-035-A4	M 16 x 1.5	8	26.8	24	19
ISO 8675-M20x1,5-035-A4	M 20 x 1.5	10	33	30	33

#### ISO 8675-NI

STAINLESS STEEL

Description	d	b	e	s	⚖️
ISO 8675-M8x1-035-NI	M 8 x 1	4	14.4	13	3
ISO 8675-M10x1-035-NI	M 10 x 1	5	17.8	16	6
ISO 8675-M12x1,5-035-NI	M 12 x 1.5	6	20.1	18	8
ISO 8675-M16x1,5-035-NI	M 16 x 1.5	8	26.8	24	18
ISO 8675-M20x1,5-035-NI	M 20 x 1.5	10	33	30	31
ISO 8675-M24x2-035-NI	M 24 x 2	12	39.6	36	35